

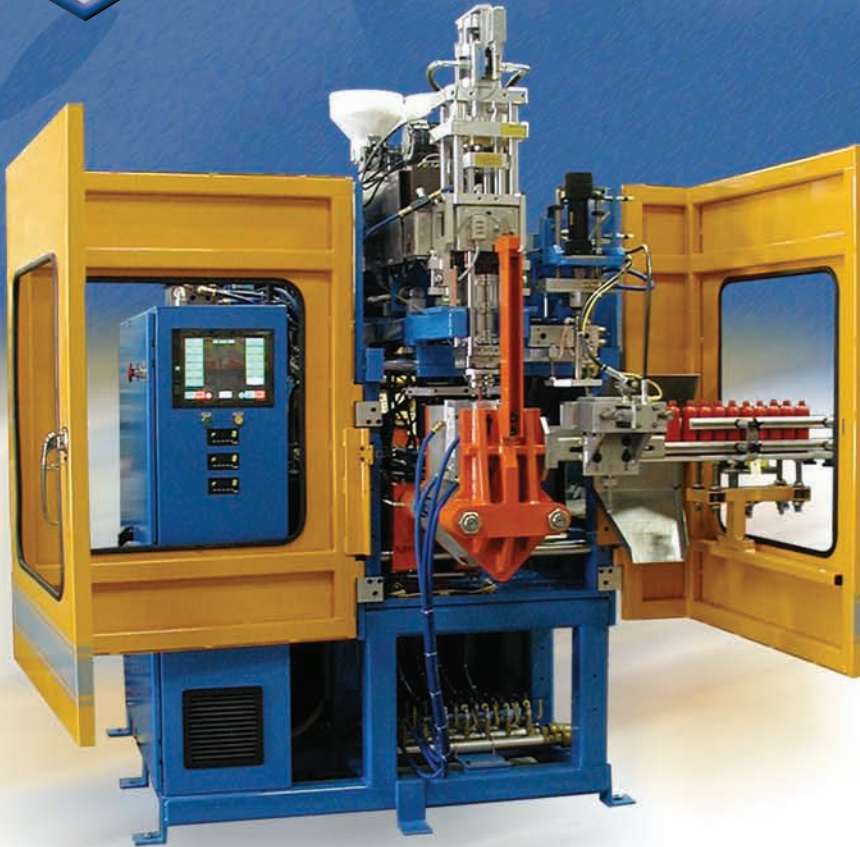

## Model CS-1 Continuous Extrusion Blow Molding Machine

# CS-1



Continuous extrusion bottle production with calibrated neck finish. Shuttle clamp with standard bottle de-flash and oriented part take away system.



- ▶ 50mm (2.0") extruder unit with 120 lbs./hour throughput HDPE.
- ▶ Up to 4-parison die heads, multi-layer co-extrusion systems, bottle de-flash system standard. Production for round, oval, off-center neck bottles.
- ▶ Optional feed screws and die heads for engineering grade resins.



# CS-1 Specifications

## Hydraulic - Modular Power Unit

- Dual pressure compensating pumps, one for extruder drive, one for machine functions
- Recirculator pump for continuous oil filtration and cooling
- 100 gallon reservoir with level/temperature safety sensor
- Full proportional valve controls
- 2,000 PSI maximum system pressure

## Extruder

- 2" (50 mm) diameter 24/1 ratio (L/D) screw, Stellite flights
- Bi-metallic barrel
- Continuous high torque hydraulic motor screw drive (0-130 RPM)
- 120 lbs./hr (55 kg) HDPE output
- Stainless steel hopper, 75 lbs. (34 kg) capacity
- Hydraulic extruder lift with air-operated hot knife for parison cutting

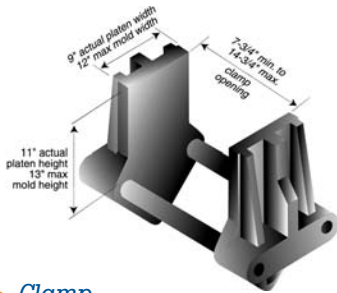

## Clamp

- 5 tons force
- 2.5" bore x 7" stroke hydraulic cylinder
- 7.75" minimum mold shut height
- 7" maximum mold daylight
- Adjustable mold daylight
- Rapid closing with deceleration control

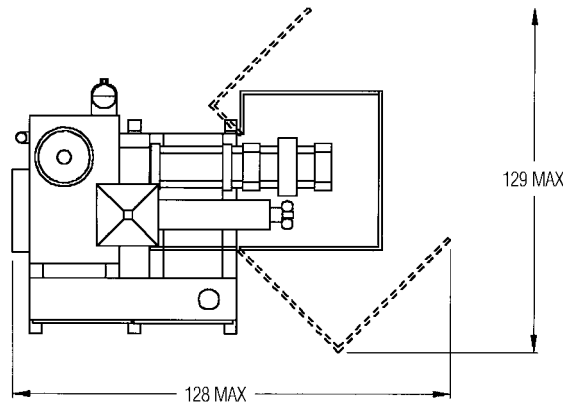

Notice: The company reserves the right to incorporate any changes in design without obligation to make these changes on units previously sold.

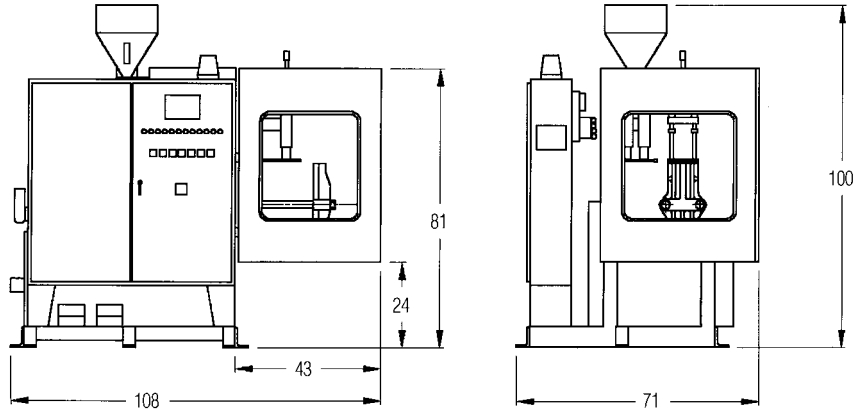

## General

- 6,000 lbs. net weight
- 5 tons chilled water required, molds and machine
- 20 CFM @ 100 PSI compressed air required

## Electrical

- 40 HP, 1800 RPM, 230/460 volt, 3 phase, 60 Hz motor
- Solid state programmable controller
- Solid state touchpad data access unit
- 220 volt heater bands, 10.9 Kw heater load, single head
- 3-zone extruder temperature controls, fan cooling
- Individual die head temperature controls, variac nozzle controls
- 150 amps @ 220 volts, approximately 95 running amps

## Other Standard Equipment

- File storage for multiple job setups
- RPM indicator for extruder speed
- Deflash punch actuator and transfer nest mounting brackets
- Manifold mounted air solenoid valves
- Main line coalescent air filter
- Two eight-station water manifolds
- Fully guarded with electrical interlock for operator safety
- Hopper magnet
- Machine mounting pads

CS-1 Production Capability				
	D	X	X	X
X	-	5" (127 mm)	3.375" (85.7 mm)	2.36" (60 mm)
D	5" (127 mm)	4.25" (108 mm)	3" (76 mm)	1.75" (45 mm)
H	11" (280 mm)	11" (280 mm)	11" (280 mm)	11" (280 mm)

Standard head centers listed. Systems may be modified to accommodate your specific requirements.



Rocheleau Tool & Die Co., Inc.