

# MODEL SPB-2 BLOW MOLDER



The MODEL SPB-2 blow molder is a reciprocating screw type of extrusion blow molder. It is ideal for parts up to the size of a gallon container. Many of our customers report molding much larger parts. The SPB-2 flexibility makes it an ideal machine for molding a variety of medical or industrial items, toys and containers.

## FEATURES

The MODEL SPB-2 blow molder is a most versatile machine. Mold and tooling set ups are fast and simply made, so short run jobs are economical. The machine is equally suitable for long production runs.

A bank of these blow molders will give the processor the utmost in mold and color flexibility, minimum maintenance and increased productivity.

A battery of these machines will eliminate total production shut down and enable the processor to take on short run jobs at a profit.

Molds are quickly and easily set up on ample sized platens either with screws or straps. Mold height adjustment is made with a "T" square arrangement so mold can be easily raised or lowered.

Closing of the platens is accomplished with a single hydraulic cylinder, and so arranged to insure the closing of the platens to exact center. Platen opening adjustment is made by the setting of a knob. The bi-metallic lined extrusion barrel is fitted with a positive hydraulic shut off valve to prevent drooling during return of the screw.

The extrusion unit is adjustable (6 inches) so molds with halves of different thickness can be mounted without the use of shims.

A variety of multiple cross heads are available adding to the machine versatility. When equipped with an optional 4 parison head it is capable of molding over 2,000 8 oz. containers per hour.

Machine is fully guarded. All movable guards are interlocked with electrical safety switches.



**ROCHELEAU TOOL AND DIE CO., INC.**

117 INDUSTRIAL ROAD, FITCHBURG, MA 01420 U.S.A.  
TELEPHONE (508) 345-1723 FAX (508) 345-5972

NEW AREA CODE:  
TEL: (978) 345-1723  
FAX: (978) 345-5972

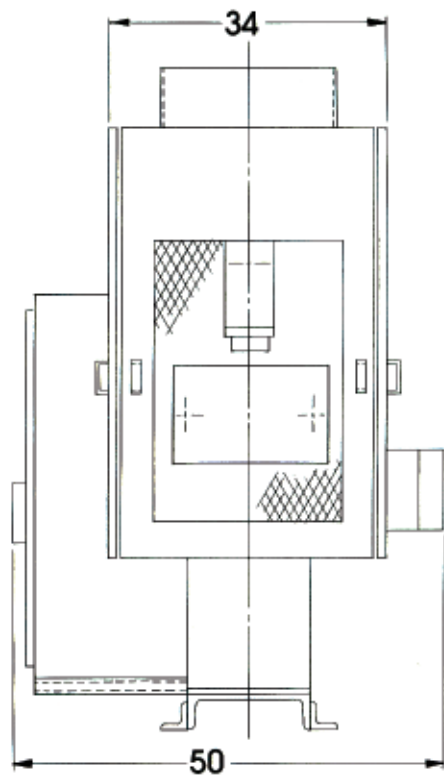
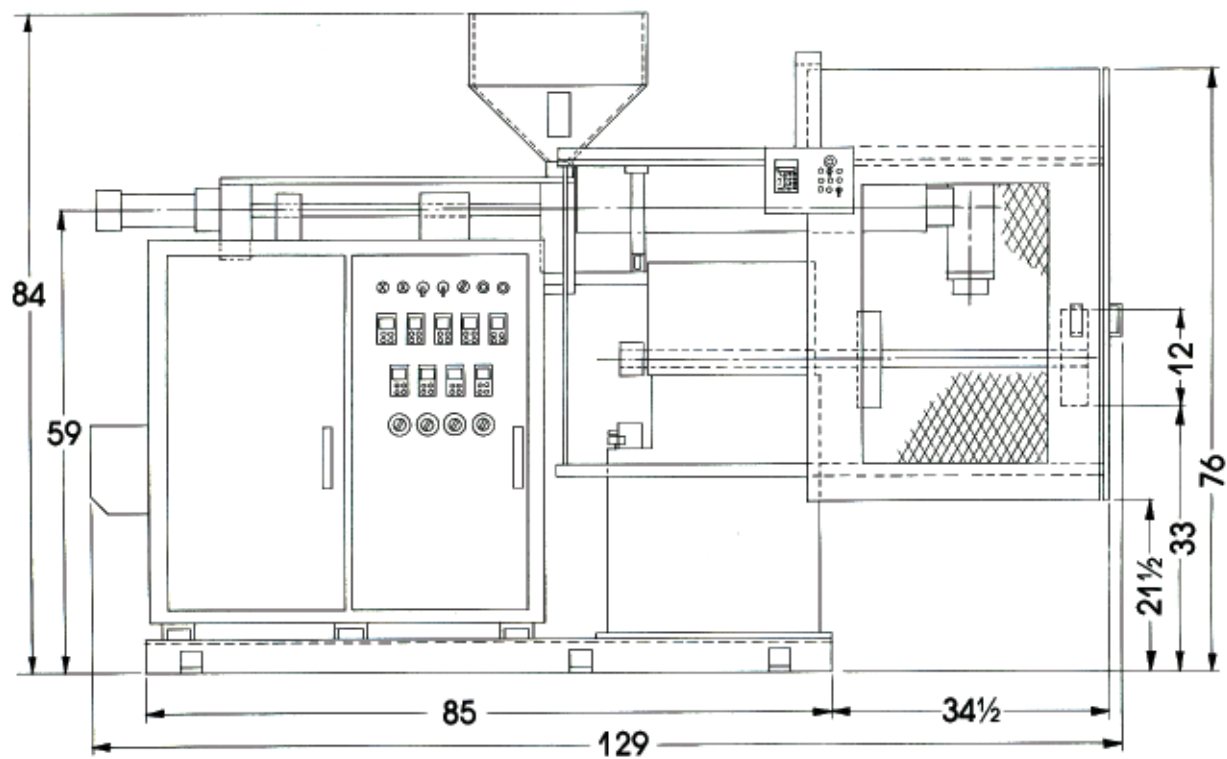

## MODEL SPB-2 SPECIFICATIONS

### SCREW MECHANISM

- SCREW: 2 in. dia., 20 to 1 L/D.
- BARREL: bi metallic
- TYPE OF EXTRUSION: reciprocating screw; 8 in. stroke
- SCREW DRIVE: hydraulic motor
- FULL SHOT: 400 grams H.D. PE.
- PLASTICIZING CAPACITY: 120 lbs. per hour
- HOPPER CAPACITY: 130 lbs.

### CLAMPING MECHANISM

- HYDRAULIC CLAMP FORCE: 16,000 lbs.
- MAX. PLATEN OPENING: 24 inches
- MIN. PLATEN OPENING: 9 inches
- DISTANCE INSIDE TIE BARS: 15 inches
- PLATEN SIZE: 49.5 x 12 inches

### HYDRAULIC

- PUMP: 23 G.P.M. 2,000 PSI
- VALVES: manifold mounted
- CYLINDERS: high pressure; 4 in. dia. x 8 in. stroke for injection; 3-1/4 in. dia. x 15 in. stroke for clamp
- OIL RESERVOIR: 32 gallons
- OIL FILTER: 10 micron with condition indicator

### ELECTRICAL

- MOTOR: 25 H.P., 1800 RPM, 220/440 volts, 3 PH, 60 Hz
- CONTROLS: 110 V. through transformer
- HEATERS: 220 V., single PH
- HEAT CONTROLS: 5 solid state pyrometers and 1 solid state variac
- HEATING WATTS: 13,100
- FULL LOAD POWER CONSUMPTION: 125 amps.

### GENERAL

- MACHINE SIZE: 129 in. long, 50 in. wide, 84 in. high
- NET WEIGHT: 3,060 lbs.
- SHIPPING WEIGHT: 3,600 lbs.

### STANDARD EQUIPMENT

- programmable controller for machine functions
- data access touch pad unit for all timers
- heat exchanger for cooling hydraulics
- main-line air filter
- manifold mounted air valves and controls
- quick exhaust valve on blow line
- top knock out attachment
- one set blank mandrel pin & bushing

### OPTIONAL EQUIPMENT

- multiple parison cross heads: double @ 7.5"cc, triple @ 4.75"cc, four @ 3.375"cc
- bottom blow attachment
- low pressure pre blow
- hopper magnet
- vibration mounts
- parison programming
- special screws
- 16 station water manifold (8 in or 8 out)

**NOTICE:** The company reserves the right to incorporate any changes in design without obligation to make these changes on units previously sold. Prices quoted are for U.S. only, and subject to change without notice. State and local taxes extra where applicable.